



Single-phase Hybrid Inverter

Quick Installation Guide

INS-3.6LV-EUA1
INS-5.0LV-EUA1

1 General Declaration

- The information in this quick installation guide is subject to change due to product updates or other reasons.
- This guide cannot replace the product labels or the safety precautions in the user manual unless otherwise specified. All descriptions here are for guidance only.
- Before installations, read through the quick installation guide and the user manual to learn about the product and the precautions.
- All installations should be performed by trained and knowledgeable technicians who are familiar with local standards and safety regulations.
- Check the deliverables for correct model, complete contents, and intact appearance. Contact the manufacturer if any damage is found or any component is missing.
- Use insulating tools and wear personal protective equipment when operating the equipment to ensure personal safety. Wear anti-static gloves, clothes, and wrist strip when touching electron devices to protect the inverter from damage. The manufacturer shall not be liable for any damage caused by static electricity.
- Strictly follow the installation, operation, and configuration instructions in this guide and user manual. The manufacturer shall not be liable for equipment damage or personal injury if you do not follow the instructions.
- All cables in this article are copper cables.

2 Packing List

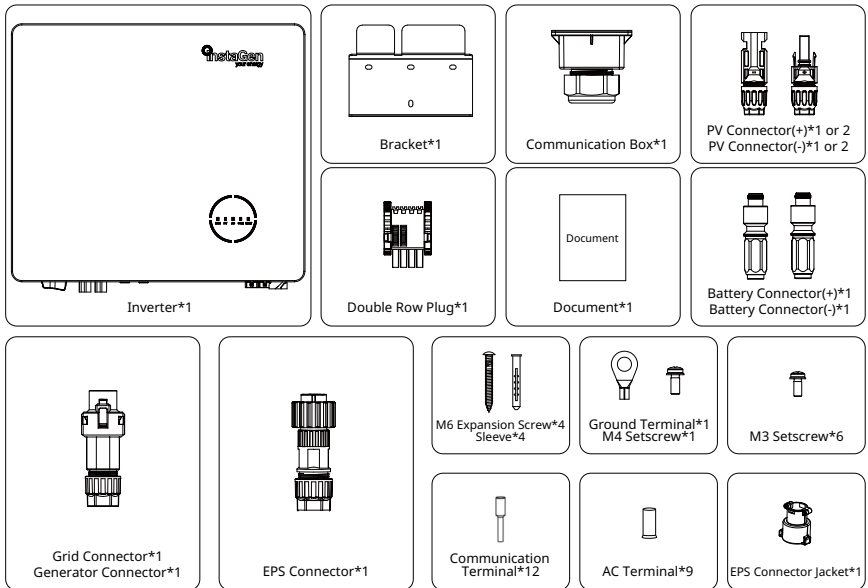

Accessories packing list

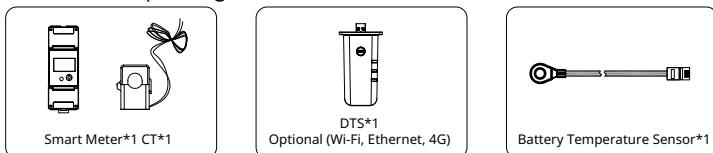



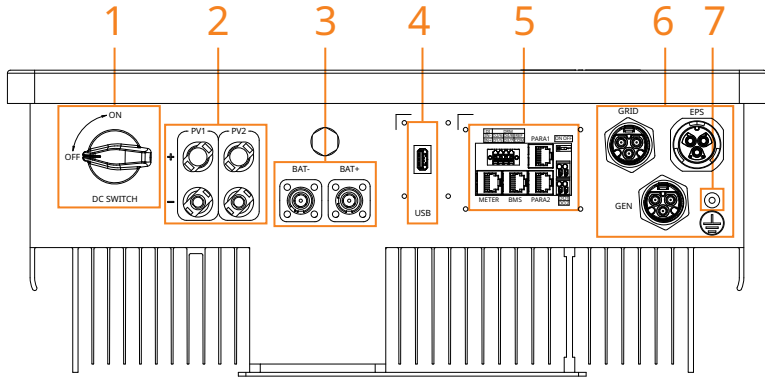

3 Product Overview

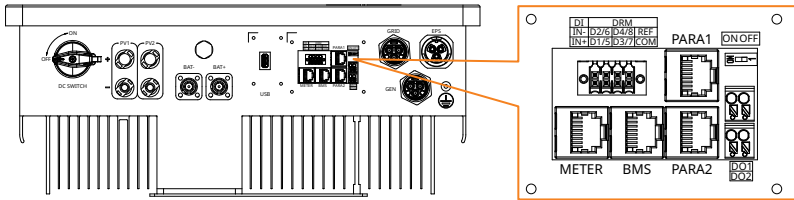

- 1. DC Switch 3. Battery Terminals 5. Communication Port 7. PE Terminal
- 2. PV Terminals 4. Data Transfer Stick (DTS) Port 6. AC terminals



DI	DRM			 Para1	8-485A_2	120 Ohm					
2	4	6	8		7-485B_2	ON	OFF				
IN-	D2/6	D4/8	REF		6-485A_1	DO1 <table border="1" style="width: 100%; border-collapse: collapse;"> <tr> <td style="width: 50%; text-align: center;">1</td> <td style="width: 50%; text-align: center;">2</td> </tr> <tr> <td style="text-align: center;">NO1</td> <td style="text-align: center;">COM1</td> </tr> </table>		1	2	NO1	COM1
1	2										
NO1	COM1										
1	3	5	7	5-485B_1							
IN+	D1/5	D3/7	COM	4-CANL	DO2 <table border="1" style="width: 100%; border-collapse: collapse;"> <tr> <td style="width: 50%; text-align: center;">1</td> <td style="width: 50%; text-align: center;">2</td> </tr> <tr> <td style="text-align: center;">NO2</td> <td style="text-align: center;">COM2</td> </tr> </table>		1	2	NO2	COM2	
1	2										
NO2	COM2										

 Meter	 BMS	 Para2
8-NC 7-NC 6-NC 5-485B 4-485A 3-NC 2-NC 1-NC	8-485B 7-485A 6-NC 5-CANL 4-CANL 3-NTC- 2-NC 1-NTC+	8-485A_2 7-485B_2 6-485A_1 5-485B_1 4-CANL 3-CANH 2-DI IN- 1-DI IN+

4 Wiring Diagram

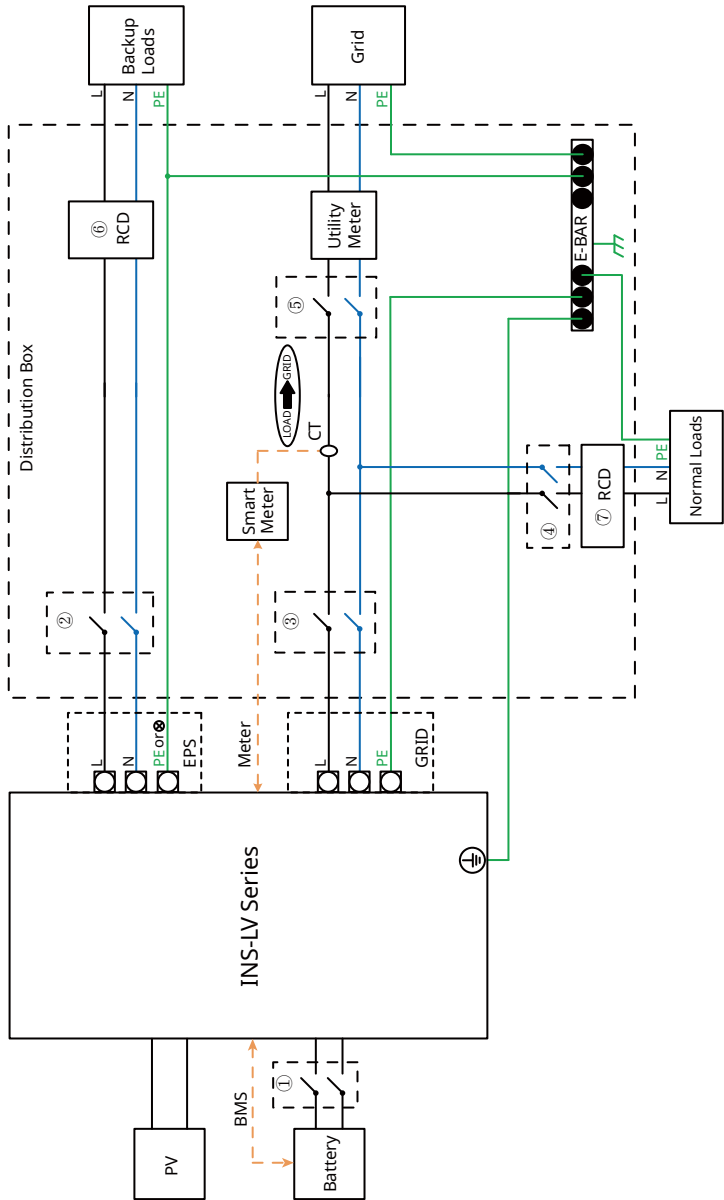

Model	①	②	③	④	⑤	⑥⑦
INS-3.6LV-EUA1	125 A/60 V DC Breaker	20 A/230 V AC Breaker	40 A/230 V AC Breaker	Depends on Loads	Main Breaker	30 mA RCD
	125 A/60 V DC Breaker	32 A/230 V AC Breaker	40 A/230 V AC Breaker			

Note:

- If the battery has integrated a readily accessible internal DC breaker, then no additional ① DC breaker is required.
- The use of ⑥⑦ 30 mA RCD is recommended but not mandatory; please comply with local regulations for the system installation.

5 Wall Mounting Steps

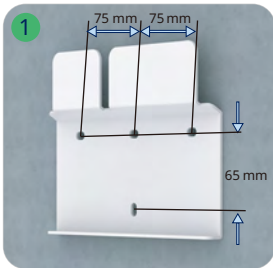
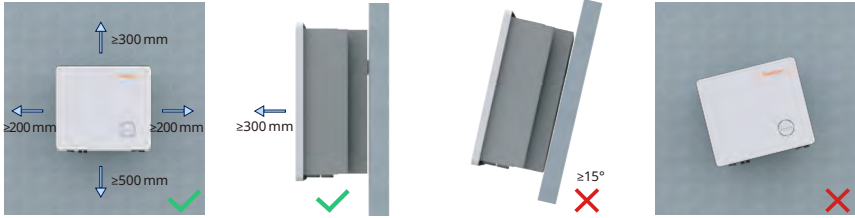

6 Electrical Connection

Step 1 PE Cable

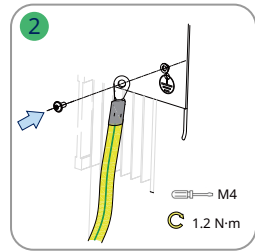
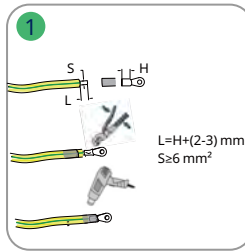
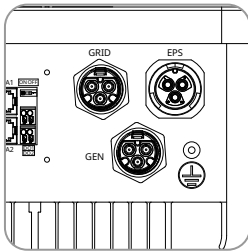

Step 2 Grid Cable (Same wirings for GEN if needed)

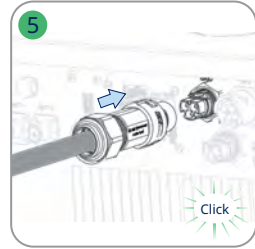
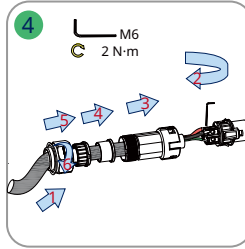
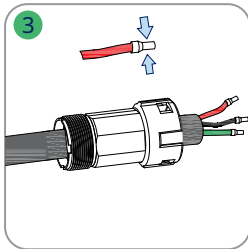
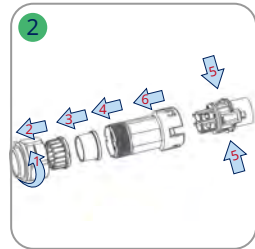
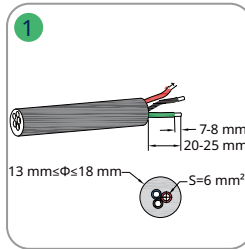
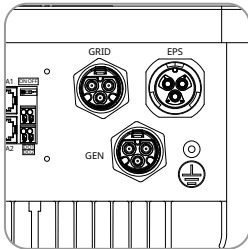

Step 3 EPS Cable

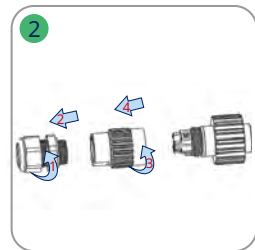
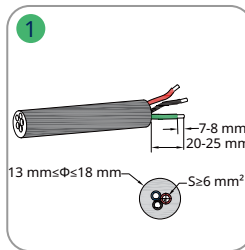
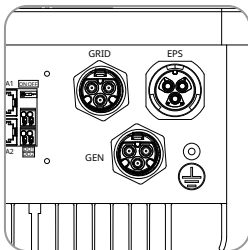

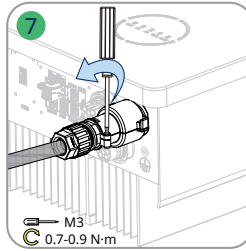
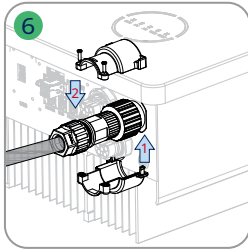
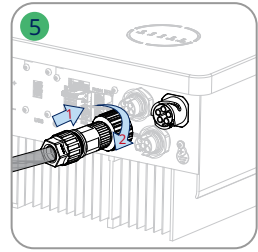
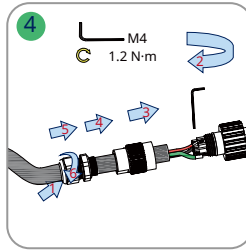
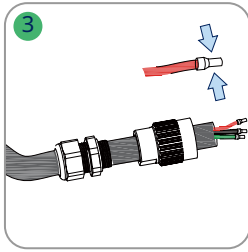

Step 4 PV Cable

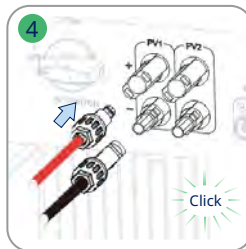
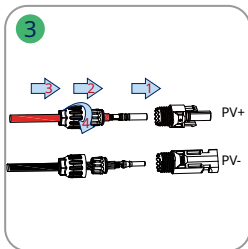
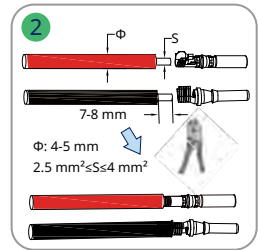
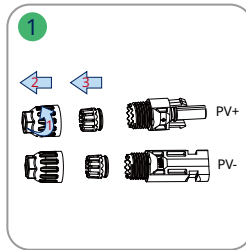
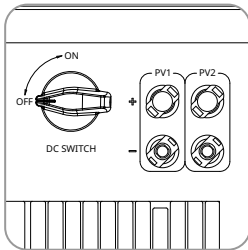

Step 5 Battery Cable

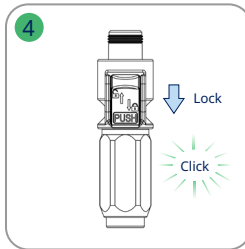
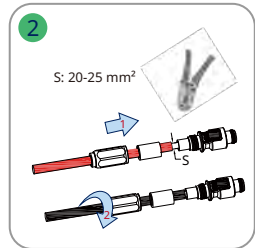
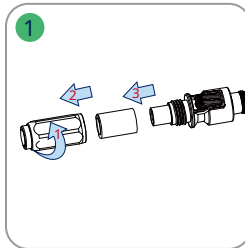
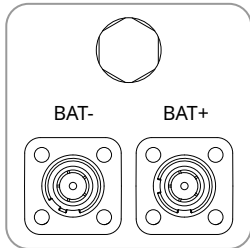

Step 6 Signal Communication (Connection of communication box is mandatory)

RJ45 Terminal Connection (METER, BMS)

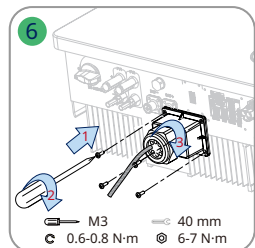
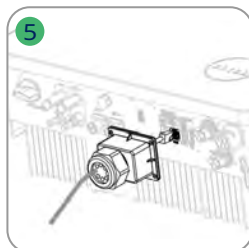
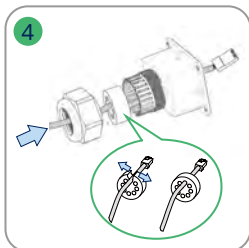
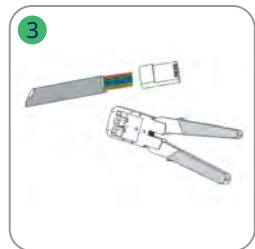
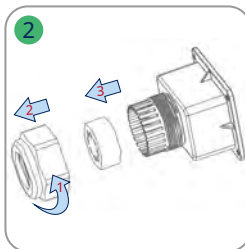
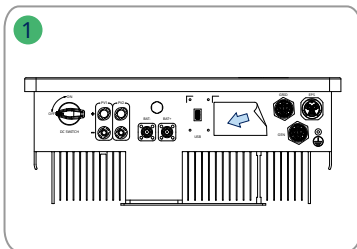

Step 7 Data Transfer Stick (DTS) Connection

Wi-Fi and 4G Connection

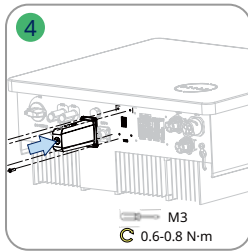
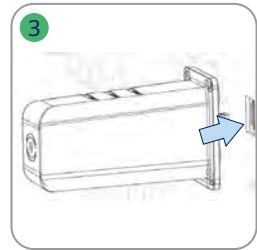
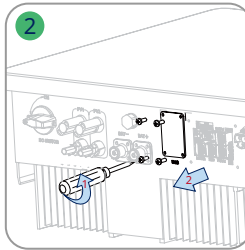
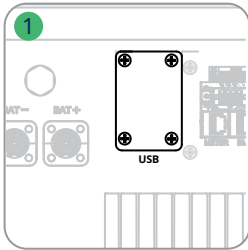

Ethernet Connection

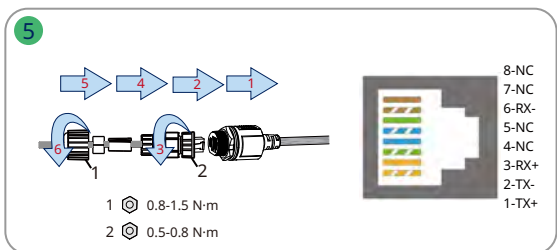
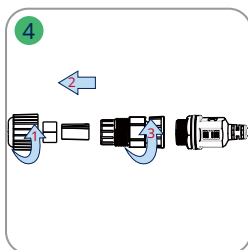
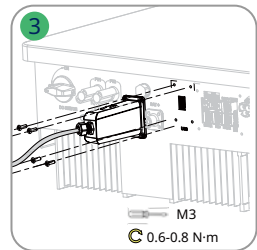
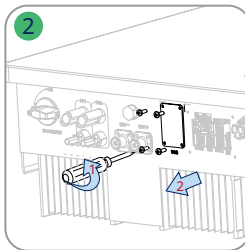
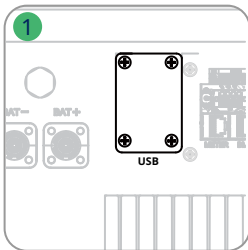



<https://www.instagroup.co.uk/technical-support>



InstaGroup Limited

Add: Insta House, Ivanhoe Road, Hogwood Business Park,
Finchampstead, Wokingham, Berkshire, RG40 4PZ, UK.

Tel: 0800 526 023

Email: info@instagroup.co.uk

www.instagroup.co.uk



AP040968